

PACKARD
Industries, Inc.

EFFICIENCY WALL™

MOVEABLE STEEL PARTITIONS



- See p. 2 for Ordering and Freight Terms
- See p. 4 for Fabric and Finish Selections
- See p. 75 for Storage & Filing and p. 85 for Seating

**EFFECTIVE APRIL 2, 2008
PLEASE USE THESE 2001 COMBINED LIST PRICES PLUS 17%!**

EFFICIENCY WALL

EFFICIENCY WALL Moveable Steel Partitions ZONE 1 LIST PRICES

ZONE ONE: Delivered Price—85 Linear Feet or More

Panels: Standard Height

Price per Linear Foot

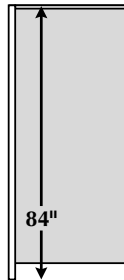
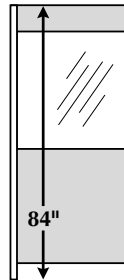
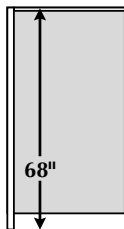
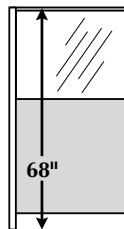
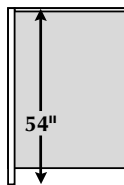
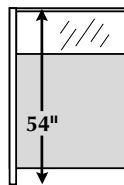
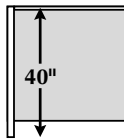

Height	Style	Baked Enamel	Vinyl	.80 NRC Acoustical Wood Grain Vinyl			Weight Per Lin. Ft.
				Fabric Std.	Fabric Std.	Grain Vinyl	
40" High	Solid	\$88.	\$116.	\$128.	\$134.	\$144.	12#
54" High	Solid	\$100.	\$160.	\$170.	\$180.	\$210.	16#
	Glass by Packard	\$100.	\$150.	\$160.	\$170.	\$200.	16#
	Glass by Customer	\$90.	\$130.	\$140.	\$150.	\$180.	14#
68" High	Solid	\$108.	\$174.	\$180.	\$190.	\$226.	19#
	Glass by Packard	\$108.	\$164.	\$170.	\$180.	\$216.	19#
	Glass by Customer	\$100.	\$150.	\$156.	\$168.	\$210.	16#
84" High	Solid	\$144.	\$214.	\$236.	\$254.	\$262.	25#
	Glass by Packard	\$144.	\$204.	\$226.	\$244.	\$252.	25#
	Glass by Customer	\$124.	\$184.	\$206.	\$224.	\$232.	18#

- Price per Linear Foot includes Panels, Posts, Wall Channels for normal installation; and one (1) Floor Anchor for every 12 linear feet, if required.
- Tempered safety glass is standard in clear or obscure pebble pattern and ships with order. Other styles and types available. Please consult the factory.
- For fractions of a linear foot, round up to the nearest whole foot.
- Order baseboard separately if required.
- Refer to "Ordering Panels" p. 73.

EFFICIENCY WALL Moveable Steel Partitions ZONE 1 LIST PRICES

Panels: Floor-to-Ceiling

Price per Linear Foot

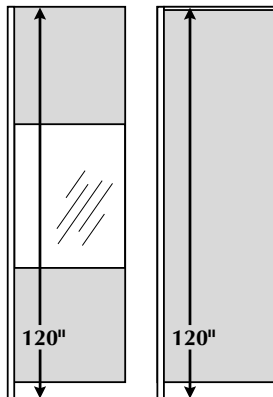

Height Not to Exceed	Style	Baked Enamel	Vinyl	.80 NRC Acoustical		Wood Grain Vinyl	Weight Per Lin. Ft.
				Fabric Std.	Fabric Std.		
96" High	Solid	\$150.	\$240.	\$254.	\$276.	\$290.	32#
	Glass by Packard	\$150.	\$230.	\$244.	\$266.	\$280.	34#
	Glass by Customer	\$144.	\$210.	\$224.	\$246.	\$260.	28#
108" High	Solid	\$170.	\$258.	\$272.	\$294.	\$332.	37#
	Glass by Packard	\$170.	\$248.	\$262.	\$284.	\$322.	39#
	Glass by Customer	\$166.	\$228.	\$242.	\$264.	\$302.	33#
120" High	Solid	\$180.	\$274.	\$288.	\$314.	\$354.	42#
	Glass by Packard	\$180.	\$258.	\$270.	\$294.	\$344.	44#
	Glass by Customer	\$178.	\$248.	\$260.	\$284.	\$324.	38#

- Price per Linear Foot includes Panels, Posts, Wall Channels, Ceiling Track for normal installation; and one (1) Floor Anchor for every 12 linear feet, if required.
- Tempered safety glass is standard in clear or obscure pebble pattern and ships with order. Other styles and types available. Please consult the factory.
- Precise maximum and minimum ceiling height dimensions are required to properly manufacture Floor-to-Ceiling Partitions.
- For fractions of a linear foot, round up to the nearest whole foot.
- Order baseboard separately if required.
- Refer to "Ordering Panels" p. 73.

EFFICIENCY WALL

Roll Screen Panels

Price Each

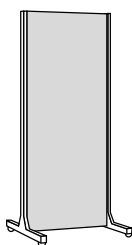

		Weight Each					
54" High Solid Panels	30" Wide	\$462.	\$606.	\$624.	\$636.	\$656.	47#
	36" Wide	\$512.	\$686.	\$706.	\$722.	\$746.	55#
	48" Wide	\$614.	\$844.	\$872.	\$892.	\$926.	71#
68" High Solid Panels	30" Wide	\$464.	\$636.	\$656.	\$668.	\$690.	55#
	36" Wide	\$516.	\$722.	\$746.	\$758.	\$786.	64#
	48" Wide	\$618.	\$892.	\$926.	\$940.	\$978.	83#

EFFICIENCY WALL Moveable Steel Partitions ZONE 1 LIST PRICES

Doors and Gates Price Each

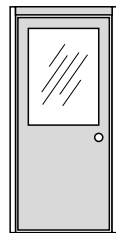
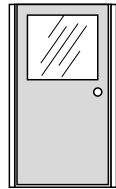
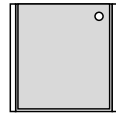

Height	Style	Baked Enamel	Vinyl	Fabric Std.	Wood Grain Vinyl	Weight Each
40" High Gate	Single Action	\$526.	\$630.	\$664.	\$736.	35#
	Double Action	\$672.	\$816.	\$858.	\$952.	40#
68" High Doors	Solid	\$612.	\$790.	\$831.	\$924.	50#
	Glass by Packard	\$660.	\$802.	\$844.	\$936.	50#
	Glass by Customer	\$648.	\$792.	\$834.	\$926.	45#
84" High Doors and Headers	Solid	\$732.	\$928.	\$978.	\$1084.	65#
	Glass by Packard	\$790.	\$942.	\$990.	\$1098.	65#
	Glass by Customer	\$776.	\$930.	\$978.	\$1086.	60#
84" High Door Header Only	Solid	\$144.	\$188.	\$200.	\$220.	6#

Ceiling High Doors Price Each

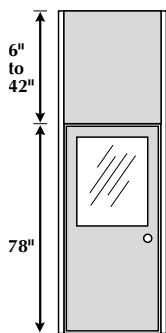

85" - 120" High Header Only:
Price per Linear Foot

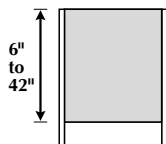

85" to 120" High Door and Header	Solid	\$840.	\$1062.	\$1116.	\$1238.	80#
	Glass by Packard	\$900.	\$1078.	\$1134.	\$1256.	80#
	Glass by Customer	\$888.	\$1064.	\$1120.	\$1240.	75#
85" to 120" High Header Only	Price per Linear Foot	\$86.	\$124.	\$130.	\$144.	10#/LF
Lock Sets (Add)	Standard	\$24.	\$24.	\$24.	\$24.	1#
	Handicap ADA Leverset	\$178.	\$178.	\$178.	\$178.	1#

- Price each includes steel Door, Hinge and Strike Post, Floor Anchors, Passage Knob Set, Glass, Door Header, and Ceiling Track as required.
- Clear tempered safety glass is standard and ships with order. Other styles and types available. Please consult the factory.
- All doors and gates are 36" wide (nominal) with ADA-compliant 32" clear opening. Other sizes available. Please consult the factory.
- Refer to "Ordering Doors and Gates" p. 73.

CALL: (800) 253-0866

70

FAX ORDERS TO: (269) 684-2422

EFFICIENCY WALL Moveable Steel Partitions ZONE 1 LIST PRICES

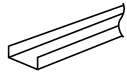
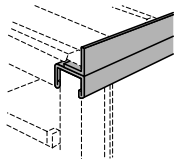
Accessories				Replacement Parts					
• Additional items which may be added to a basic requirement. Order in addition to basic items.				• Items already included in pricing. Order as replacement items.					
Baseboard	EBBD-	Per Linear Foot	\$20./LF	Posts	ECP-	40" High	\$54.		
						54" High	\$62.		
Single Electrical Outlet on Post	E/P-		\$44./Ea.			68" High	\$82.		
						84" High	\$96.		
Double Electrical Outlet on Post	D E/P-		\$54./Ea.			85" to 120" High	\$160.		
						144" High	\$176.		
Bookshelves 10" Deep x 6" High	BS-	36" Wide	\$128.	Wall Channels	EWC-	40" High	\$48.		
		48" Wide	\$172.			54" High	\$54.		
		60" Wide	\$214.			68" High	\$70.		
Wall Channel 4" to 10" Deep Up to 120"H	EWC-	\$10./LF	84" High			\$78.			
						85" to 120" High	\$98.		
Glass Pass Through	GPTO-	10" x 20" Cut-Out	\$388./Ea.			Glass Side Channels (pr.)	ESC-	54" High	\$8.
				68" High	\$10.				
				84" to 120" High	\$14.				
Glass Pass Through Shelf	GPTS-	8" x 18"	\$168./Ea.	Glass Per Linear Foot	EGSC-	54" High	\$20.		
						68" High	\$24.		
						84" to 120" High	\$34.		
Glass Speak Hole	GSH-	5" Dia. Hole	\$268./Ea.			• + \$176.00 boxing charge for each 250 lb. of glass			
Additional Floor Anchors	F/A (pair)		\$42./Pr.	Post Caps	ECAP-		\$4./Ea.		
Linear Foot Price includes one (1) Floor Anchor for Every 12 Linear Feet				Bottom Post Glides and Inserts				EPG-	\$14./Ea.
Special Color Baked Enamel per job, per color	SBE		\$352.	Keyhole Covers	EKH-	3 per pkg.	\$5.		
Floor-to-Ceiling Floor Channel	FC-84		\$12./LF	Vinyl Glass Cap	EGC-		\$4./LF		
Suspended Ceiling "H" Channel	HC-84		\$16./LF						

EFFICIENCY WALL

Panel Sizes and Styles

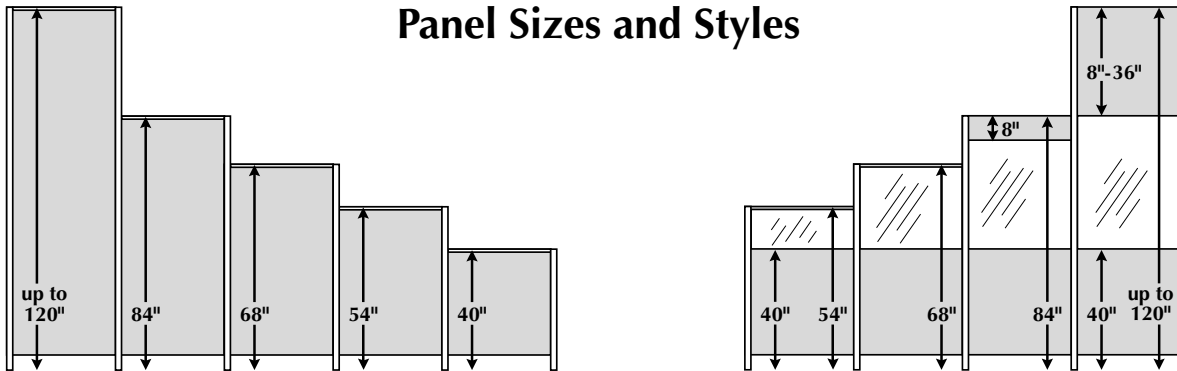

Standard Panel Widths

Special Width Panels Available at No Additional Charge.

Panel Width Center to Center of Post	12"	18"	24"	30"	36"	42"	48"	54"*	60"*†	* Not available in 84" to 120" Solid † Not available in Vinyl
--------------------------------------	-----	-----	-----	-----	-----	-----	-----	------	-------	--

IN GENERAL:

- Please also refer to "Terms and Conditions of Sale" p. 2.
- Begin by making a layout drawing or simple sketch for accurate ordering and installation. Your drawing should include:
 - Room dimensions with location of walls, columns, and obstructions.
 - Partition layout with all available dimensions and location of aisles.
 Include your drawing when faxing orders to Packard.
- Using your sketch, make a list of the panels you will need to order.
- All orders must be accompanied by a complete, **signed** purchase order. **PACKARD CANNOT ENTER ORDERS WITHOUT COMPLETE INFORMATION** including the following:
 - Purchase order number and date
 - Correct and complete **bill to** and **ship to** information
 - Freight terms: **collect, prepaid, or prepaid and add**

to the NET material invoice

- Salesperson's name, phone and fax numbers
- Any special **mark for** information
- Detailed product information including product description; model number and quantity; heights, finishes, and type of glass; and any special notes.
- Your layout drawing.

- Fax your purchase order to **Order Expediting at (269) 684-2422**.
- Packard will acknowledge your order with our standard form. This acknowledgement will also contain pricing information and expected shipping dates. **It is the customer's responsibility to check this acknowledgement for accuracy, and notify Packard immediately of any inaccuracies, as no order changes are possible after 7 days from receipt of your standard lead time order.**

Illus. #1:

Converting price per linear foot to price per panel

To convert linear foot pricing to per panel pricing, simply multiply the price per linear foot by the width of the panel. **FOR EXAMPLE:** If a 68" high solid panel is \$200.00 LIST per linear foot:...

The price of a 36" wide by 68" high solid panel would be:
3 linear feet X \$200 per linear foot = \$600.00 LIST.

The price of a 42" wide by 68" high solid panel would be:
3.5 linear feet X \$200 per linear foot = \$700.00 LIST.

Illustration #2: A nominal 36" wide panel measures:

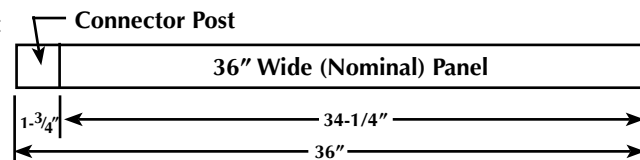

Illustration #3:
Panel Dimension Chart

Nominal Panel Width	18"	24"	30"	36"	42"	48"	54"	60"
Actual Panel Width (Panel + One Post)	18"	24"	30"	36"	42"	48"	54"	60"

ORDERING EFFICIENCY WALL PANELS:

Working with linear foot pricing:

- In order to simplify quotation and ordering, EFFICIENCY WALL panels are priced per linear foot. Thus, each standard panel height and style (solid, half glass, etc.), has a different price per running foot. This price per foot includes all universal post connectors, panel trim, wall channels, etc., required for an ordinary installation.
- Simply indicate as a line item on your purchase order the total footage of each panel height, by panel style; Packard will determine actual individual panel widths based on the requirements of your final partition layout, and indicate them on your order acknowledgment. Or, if you prefer, you may specify each individual panel size on your purchase order (illustration #1).
- If the final total footage of any panel style is a fraction, round up to the next full linear foot. If you require a special panel height, simply use the next highest standard panel height price per linear foot.
- The EFFICIENCY WALL price per linear foot includes all universal connector posts for an ordinary installation. EFFICIENCY WALL connector posts are 1-3/4" square, and are punched on all four sides to accept all standard EFFICIENCY WALL panel heights. Thus, there is no need to specify individual connectors, or special high-low connectors, for any panel connection condition.
- EFFICIENCY WALL panels are (nominal) 1-5/8" thick.
- Panel widths are measured to include one panel and one post (illustration #2 & #3).

ORDERING FLOOR TO CEILING PANELS:

- Order floor to ceiling panels exactly as you would less-than-ceiling high panels, as described above. There are a few additional simple considerations:
- Precise maximum and minimum ceiling heights are critical for Packard to properly manufacture your floor to ceiling order. When measuring ceiling height, take dimensions near where the floor to ceiling panels will connect to the building wall, as well as near the center of the room. If there is more than 1" of variance over the area your floor to ceiling panels will be installed, take several measurements, and Packard will recommend an actual panel dimension.
- Be especially aware of any building obstructions where your floor to ceiling panels will attach, such

as baseboard molding, outlets, light switches, thermostats, electrical access doors, ceiling light fixtures, heat or air conditioning vents, etc.

- The ceiling track for floor to ceiling panels attaches directly to the ceiling grid; be aware of the type of ceiling tiles in use so that you select the correct fasteners when you install the ceiling track.
- When you have determined the ceiling height, use the next highest standard Packard price per linear foot to determine your floor to ceiling panel pricing. For example, if your ceiling measures 105'-3/4", use the 108" high linear foot price; if your ceiling measures 109", use the 120" high linear foot price.

ORDERING DOORS AND GATES:

- EFFICIENCY WALL doors and gates are priced each; this price each includes hinge and strike post connectors, floor anchors, knob passage set, etc. Please consult the price list or the factory for other lock options.
- All standard doors and gates have an ADA-compliant 32" clear opening. Please consult the price list or the factory for custom widths.
- Door headers are available up to 42" high, and 120" wide, for openings with no doors. Headers are priced per linear foot.
- When ordering doors or gates less than 84" high, there is no door header. For maximum stability of doors in these applications, locate the door in the center of a panel run. Avoid locating either the hinge or strike post at the end of a panel run or the in the corner position of a workstation. If you must locate a low height door in one of these locations, please consult the factory for advice on increasing stability in these applications.

ORDERING FLOOR ANCHORS:

- One floor anchor per 12 linear feet is included in the EFFICIENCY WALL linear foot price. You may desire additional floor anchors for maximum stability on various types of panel configurations, such as long, straight panel runs with no wing panels. Please consult the factory for advice on the necessity of ordering additional floor anchors in these applications.

ORDERING OPTIONAL PANEL BASEBOARD TRIM:

- EFFICIENCY WALL baseboard is always ordered separately, and can be added to the panels at the time of installation, or retrofit to an existing installation. EFFICIENCY WALL baseboard is for trim purposes only, and "floats" up to 1-1/2" with the rise and fall of the floor to provide a flush-to-floor appearance.

It is not designed to be electrified. Aluminum post plinths are included in the baseboard price per linear foot, and cover the bottom of the connector posts to maintain the flush-to-floor appearance at the posts (illustration #4).

Illustration #4:
Optional baseboard trim

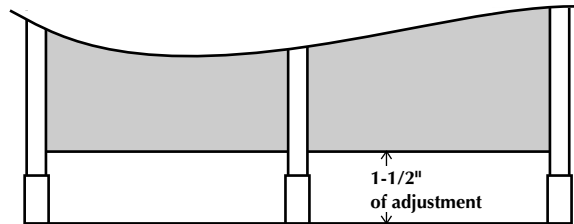

EFFICIENCY WALL SPECIFICATIONS

In General: EFFICIENCY WALL partitions shall be of panel and post construction. The EFFICIENCY WALL spring-loaded panel stud shall permit the easy assembly of panels to posts in a variety of flexible combinations. Various components such as upper panels, side channels, floor anchors, wall fillers, doors and trim are designed for simple installation, good appearance and function.

Material: Best quality steel, paint, and hardware. External surfaces shall be uniform and free of defects. All painted surfaces are spray coated with specially formulated high temperature baked enamel.

Panels: Panels shall be 1-3/4" thick (nominal dimension); furniture grade steel, resistance welded on the panel periphery. A small cell, full honeycomb core shall be tightly bonded to the steel skins with a specially-formulated adhesive. There shall be spring-loaded studs integrally welded into each panel. Studs shall be provided with Phillips head to permit screwdriver adjustment of tension between panel and post either before or after assembly.

Baseboard: Optional baseboard shall be heavy gauge steel, easily and quickly mounted either during or after partition installation. There shall be 1-1/2" adjustment vertically. Baseboard shall be finished in baked enamel.

Posts – Steel: Post shall be square 1-3/4" x 1-3/4" of heavy gauge steel electric welded tubing. All four surfaces of post shall be pierced with keyhole slots to accept panels on any side of post. Molded nylon cover buttons shall be furnished with each post. An adjustable non-skid leveling glide inserted into a molded nylon base shall permit proper height adjustment of up to 2." Top cap of molded nylon shall permit a flush appearance while retaining the side channels in correct position.

Interlocking: All PACKARD components shall easily interlock and assemble to each other without use of special tools. PACKARD partitions can be easily joined to other partition systems by using the PACKARD CONVERTI-POST® (optional).

Post – Electrical: Electrical post shall have U/L approved cord set and receptacle in post. Three wire, grounded plug type.

Wall Channels: Wall Channels shall be heavy gauge steel "U" channels providing a finished appearance of panel installation. Wall Channel shall be mounted to the wall and then the initial post inserted, thus starting a panel run.

Side Channels: Side channels shall be extruded and shall retain upper glass and other upper panels in place.

Glass: Glass shall be obscure or clear tempered safety glass. Meets A.N.S.I. #Z-97, 1-1972 standard, which meets or exceeds OSHA, federal, state and local safety codes.

Floor Anchors: Shall be wrap-around heavy castings permitting installation either during or after partition assembly.

Ceiling High: Shall be of the same general construction as above. Maximum width panel is 48" nominal. Maximum height is 10'0". Heavy gauge – U-shaped ceiling channel will be supplied.

Acoustical Panel: Perforated steel skins, with a 23% open area bonded to honeycomb core, resistance welded on the panel periphery. Compressed 1/4" fiberglass covered with 100% polyester fabric.

Doors: Doors shall be of the same general construction as panels, conform to the general appearance of partition system, and be finished to match partitions. Doors furnished complete with jambs and hardware.

Bookshelves: Shall be constructed of heavy gauge steel suitably designed to carry heavy shelf load. Bookshelf shall be finished to conform with partitions.

Finishes: Available in a variety of colors and textures.

Baked Enamel: Metal surfaces shall be cleaned, phosphatized and double sprayed. High solids baked enamel shall be used. Finish shall be electrostatically applied and shall undergo deep-bake cycle at a temperature of 350°F.

Vinyl: Vinyls shall be fabric backed textured material; fade, stain, and scuff resistant. Flame spread—14, smoke factor—10.

Panel Fabric: Fabric shall be 100% polyester. Flame spread—0, fuel contribution—0, smoke developed—14. All above Packard finishes are class "A" fire rated.

High Pressure Laminate: Plastic Laminate shall meet Federal Standard LP-508G and Motor Vehicle Safety Standard 302 Flammability.

Shop Blueprints: Drawings showing partition layout by panel size furnished upon request.

Packing: All components shall be shipped in properly designed shipping containers and palletized whenever possible.

Workmanship: Packard products shall be constructed using only the best quality materials and workmanship. There shall be no rough edges or defects.

Performance Tests: System shall meet or exceed the following: BIFMA First Generation Voluntary Panel Systems.

Standard Sound Absorption Test – ASTM C-423-81 – NRC .85

Flame Spread Tunnel Test – ASTM E84 – 81A – rated Class "A."

U.L. Listed – File #78415

Tests available upon written request.

Dimensions: All listed dimensions are nominal. Consult ordering notes or factory for precise dimensions.